



# NSF Day at San José State University

## March 13, 2008



### Agenda

- 7:30 - 8:30 a.m.**      **Registration and Continental Breakfast** (Barrett Ballroom)
- 8:30 - 8:45 a.m.**      **Welcoming Remarks**  
*Pamela Stacks, Associate Vice President, Graduate Studies and Research*  
*Don W. Kassing, President, San Jose State University*
- 8:45 - 9:30 a.m.**      **Introduction to NSF – The Basics**  
*George Wilson, Legislative Specialist, Office of Legislative and Public Affairs*
- 9:30 – 10:30 a.m.**      **NSF Proposal and Merit Review Process**  
*Donald Elthon, Program Officer, Division of Ocean Sciences, Directorate for Geosciences*
- 10:30 – 10:45 a.m.**      **Break**
- 10:45 – 11:30 a.m.**      **Cross-Disciplinary and Special Interest Programs**  
*George Wilson*
- 11:30 – 12:15 p.m.**      **International Programs**  
*Wayne Patterson, Program Manager, Office of International Science and Engineering*
- 12:15 – 1:30 p.m.**      **Lunch** (restaurant options and locations can be found in your packet of materials)
- 1:30 – 2:45 p.m.**      **Concurrent Directorate Sessions (room assignments and map on reverse)**
- **Biological Sciences** - *Sally E. O'Connor, Program Director, Division of Biological Infrastructure*
  - **Computer & Information Science & Engineering** - *Douglas H. Fisher, Program Director, Division of Information and Intelligent Systems*
  - **Education and Human Resources** - *John C. Cherniavsky, Senior EHR Advisor for Research, Division of Research on Learning in Formal and Informal Settings*
  - **Engineering** - *Juan E. Figueroa, Program Director, Division of Industrial Innovation and Partnerships*
  - **Geosciences** - *Donald Elthon, Program Officer Division of Ocean Sciences*
  - **Mathematical and Physical Sciences** - *Morris L. Aizenman, Senior Science Associate*
  - **Social, Behavioral, and Economic Sciences** - *Judith S. Sunley, Deputy Assistant Director*
- 2:45 – 3:00 p.m.**      **Break and Refreshments**
- 3:00 – 4:00 p.m.**      **Concurrent Breakout Sessions** (informal conversations with program managers from BIO, MPS, CISE, ENG, SBE, EHR, GEO)
- 4:00 p.m.**              **Adjourn**

## NSF Day at SJSU Breakout Session Room Assignments

NSF DIRECTORATE	MEETING ROOM
• Biological Sciences	• Almaden Room
• Computer & Information Science & Engineering	• Guadalupe Room
• Education and Human Resources	• Costonoan Room
• Engineering	• Pacifica Room
• Geosciences	• Pacheco Room
• Mathematical and Physical Sciences	• Ohlone (Council Chambers)
• Social, Behavioral, and Economic Sciences	• Umunhum Room

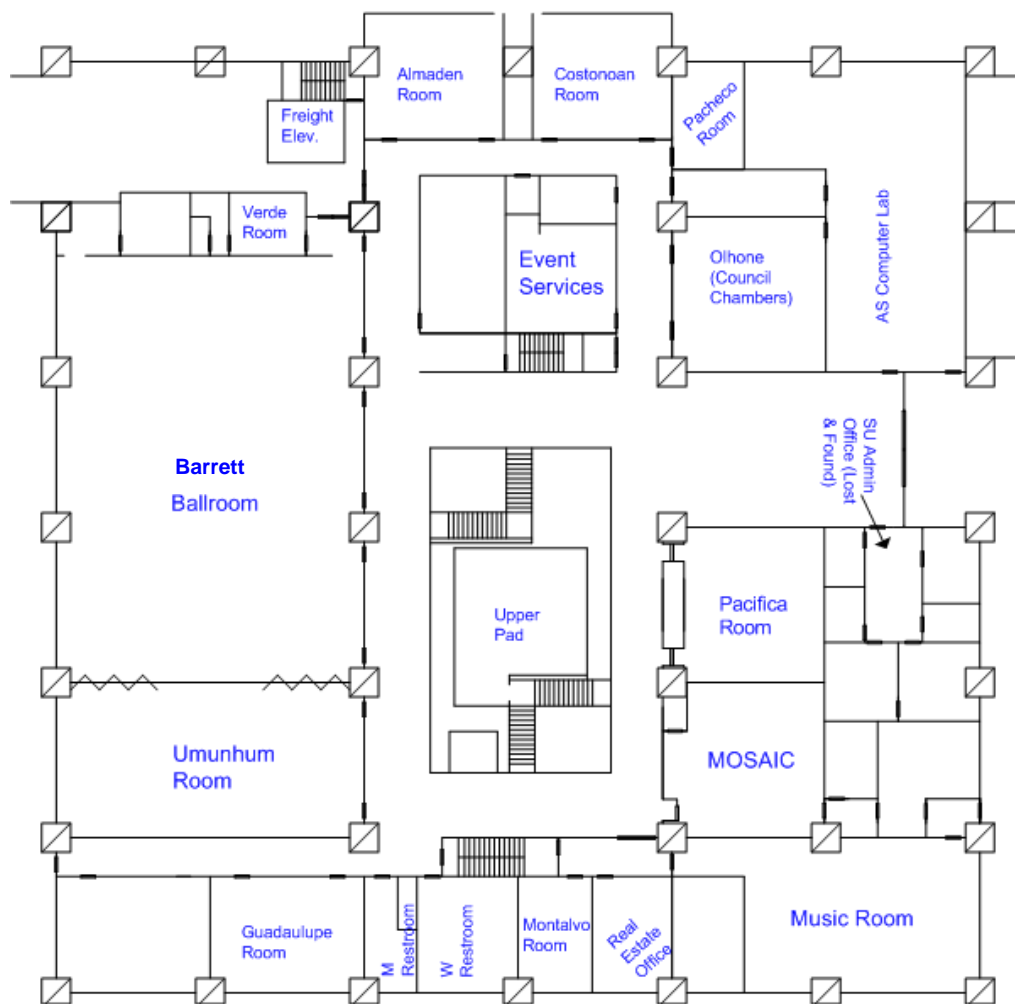

**\*Please note: Additional restrooms are located on 1<sup>st</sup> and 2<sup>nd</sup> levels of the Student Union.**